

GU



■ GU型-高真空(压力)球阀

- GU型高真空(压力)球阀用于接通或切断真空(压力)系统管路中的介质流。应用于真空、乳制品、酒业、生物工程、食品、制药、饮料、化妆品及化工领域。

■ GU

High Vacuum (Pressure) Ball Valve

- GU high vacuum (pressure) ball valve is used to put through or cut off the medium flow in vacuum (pressure) pipeline in the areas of vacuum, dairy products, breweries, biological engineering, odstuff, pharmaceuticals, drinks, cosmetics and chemicals.

■ 主要技术性能

Main Technical Performance

■ 阀门漏率: Valve Leak out Rate	≤1.3X10 ⁻⁴ Pa.L/S
■ 适用温度: Apply Temperature	-30~+150℃ -30~+150℃(PPL密封)
■ 适用范围: Apply Range	
■ 连接型式 Loose Flange	使用压力范围(Pa)
活套法兰 (GB6070、JB919)	0.6X10 ⁵ ~1.3X10 ⁴
焊接法兰 (GB6070、JB919)	1.6X10 ⁵ ~1.3X10 ⁴
快卸法兰 (GB4982)	0.1X10 ⁵ ~1.3X10 ⁴
■ 螺纹连接 Threaded Connection	1.6X10 ⁵ ~1.3X10 ⁴

■ 主要零件材料

Materials of Main Parts

- 阀体、阀盖、阀杆: 不锈钢
密封件: 四氟乙烯、丁腈橡胶、氟橡胶、PPL。
- Body, disc and stem: stainless steel
Sealing element: PTFE, NBR, Viton, PPL.

CONSTRUCTION FIGHTS(mm)

■ 外形及连接尺寸(mm)

Overall and Connection Dimensions (mm)

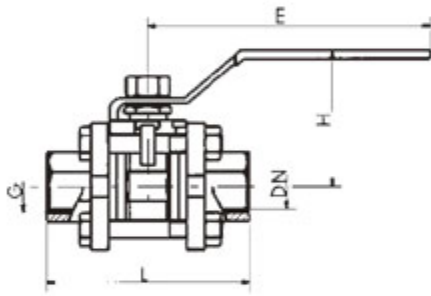

图一

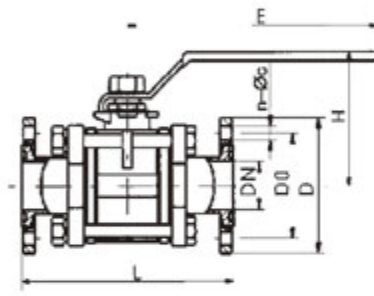

图二

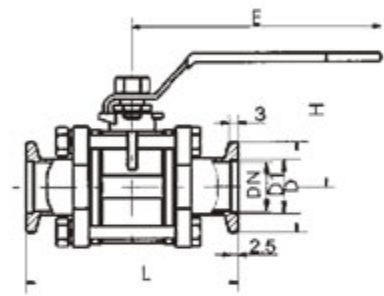

图三

■ 螺纹连接的外形及连接尺寸(图一)

Model 型号	DN	G	H	E	L
GU-10(G)	10	1/4"	52	105	68
GU-16(G)	16	1/2"	64	130	72
GU-20(G)	20	3/4"	67	130	82
GU-25(G)	25	1"	83	165	90
GU-32(G)	32	1-1/4"	89	165	112
GU-40(G)	40	1-1/2"	100	190	120
GU-50(G)	50	2"	125	190	145
GU-63(G)	63	2-1/2"	150	250	185
GU-80(G)	80	3"	161	250	210
GU-100(G)	100	4"	180	280	268

■ 活套法兰连接(GB6070)(图二)

Model 型号	DN	D	Do	H	E	L	n-φc
GU-10(F)	10	55	40	52	105	84	4-φ6.6
GU-16(F)	16	60	45	64	130	84	4-φ6.6
GU-25(F)	25	70	55	83	165	114	4-φ6.6
GU-32(F)	32	90	70	89	165	140	4-φ9
GU-40(F)	40	100	80	100	190	160	4-φ9
GU-50(F)	50	110	90	125	190	170	4-φ9
GU-63(F)	63	130	110	150	250	195	4-φ9
GU-80(F)	80	145	125	161	250	220	8-φ9
GU-100(F)	100	165	145	180	280	280	8-φ9

■ 快卸法兰连接(GB4982)(图三)

Model 型号	DN	D1	D	H	E	L
GU-10(KF)	10	12.2	30	52	105	84
GU-16(KF)	16	17.2	30	64	130	84
GU-25(KF)	25	26.2	40	83	165	114
GU-32(KF)	32	34.2	55	89	165	140
GU-40(KF)	40	41.2	55	100	190	160
GU-50(KF)	50	52.2	75	125	190	170